



WILLIAMS

WILLIAMS ALLEGRO IV IN-HOME PACK ASSEMBLY INSTRUCTIONS

Congratulations! You have just purchased a state of the art digital piano that provides remarkable acoustic sound and feel. We recommend that you read through this assembly manual carefully, so you can get the most enjoyment from your new piano.

BOX CONTENTS

The Williams Allegro IV In-Home Pack should contain the following:

Allegro IV Digital Piano

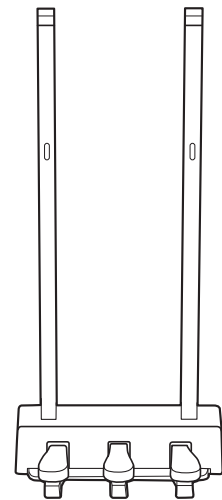
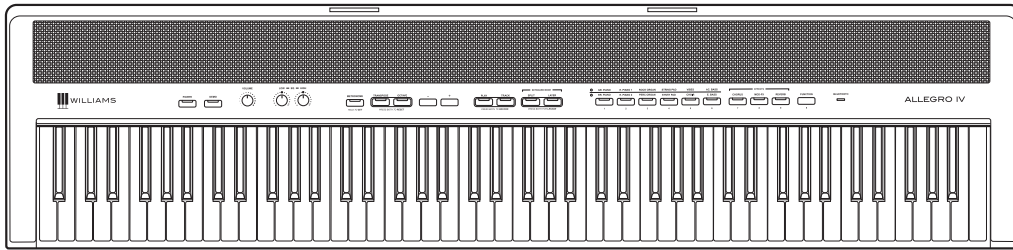

Piano-style Sustain Pedal

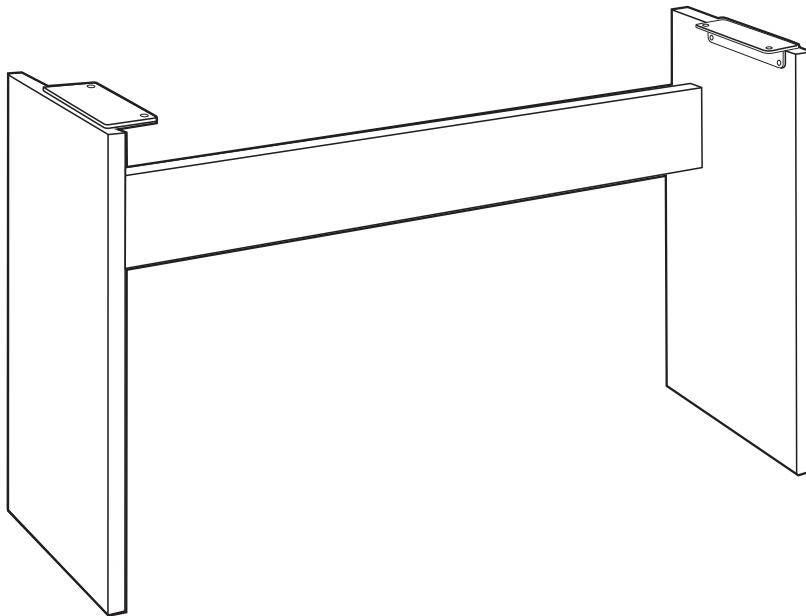

Wooden Stand

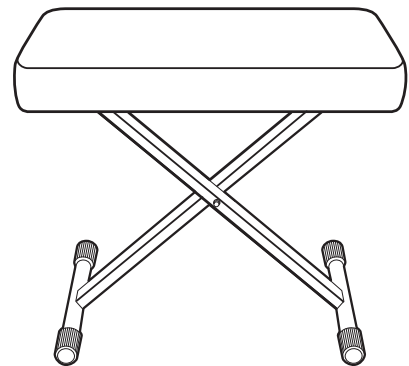

Piano Bench

Stand Parts and Hardware

A. (x4) M6 Barrel Nuts



B. (x4) M6x40 Bolt Screws



C. (x8) Screw Caps



D. (x4) M5x20 Hand Bolts

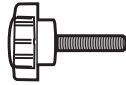

E. (x2) Phillips head screwdriver
(Not included)

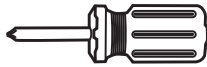

(1) Crosspiece



(2) Left Leg

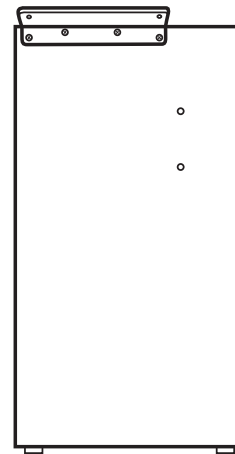

(3) Right Leg

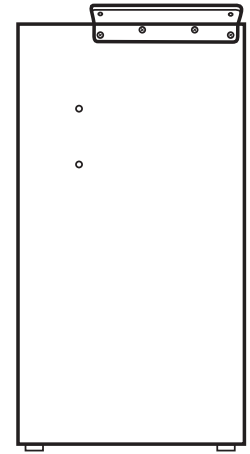

Stand Assembly

Begin assembling the piano by attaching the legs to the crosspiece.

The screw holes on the crosspiece (1) should face the back of the piano (away from the plastic supports.)

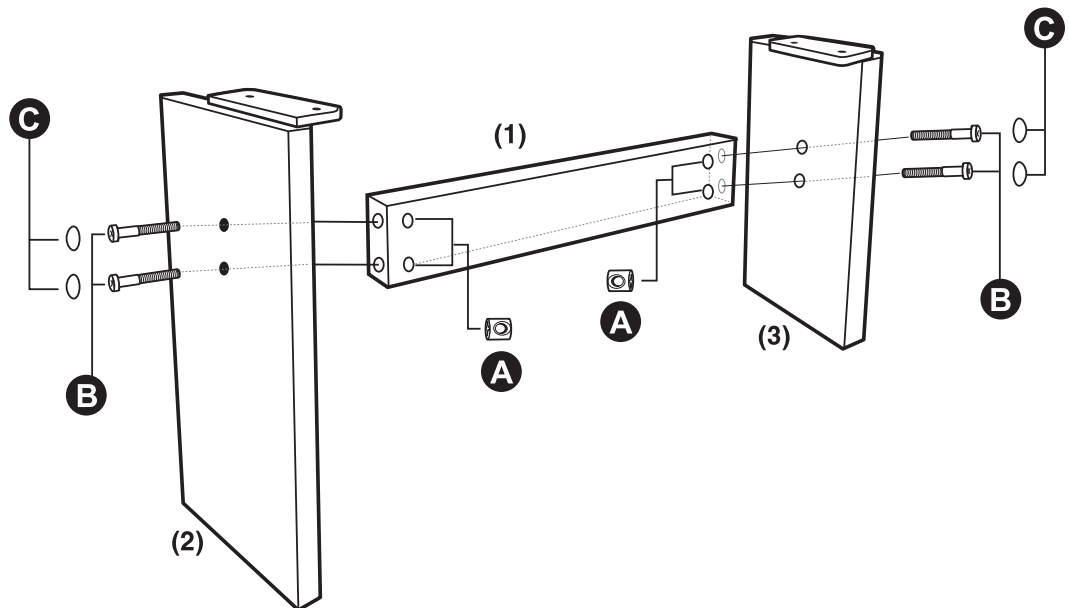

Step 1 - Attaching Legs to Crosspiece

Put the barrel nut (A) into the crosspiece as shown, making sure to align barrel nut threads with screw hole.

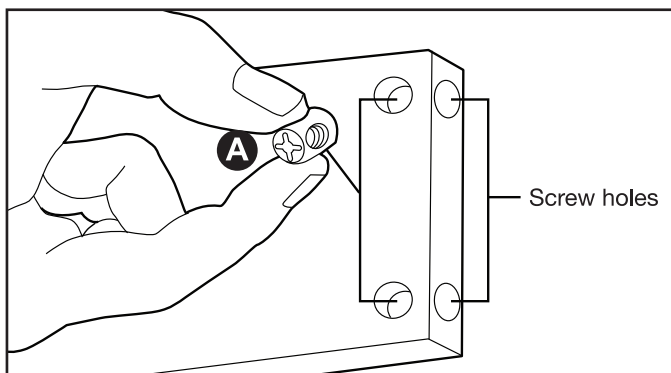

Step 2

Tighten until the crosspiece is flush with the leg brackets and the legs are firmly attached. *(Please make sure to properly fasten the bolt (B) through the leg and into the barrel nut. To avoid any cross threading use two screw drivers, one to hold the barrel nut steady and one to screw the bolt into the barrel nut.)*

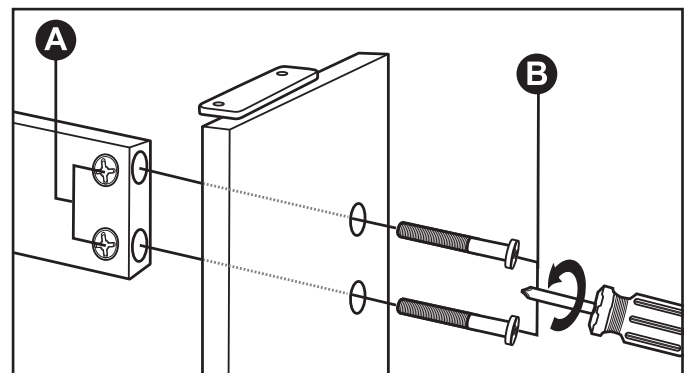

Step 3 - Finishing Touches to Stand Assembly

After attaching legs to the crosspiece, place screw caps (C) over all of the 8 tightened bolt screws.

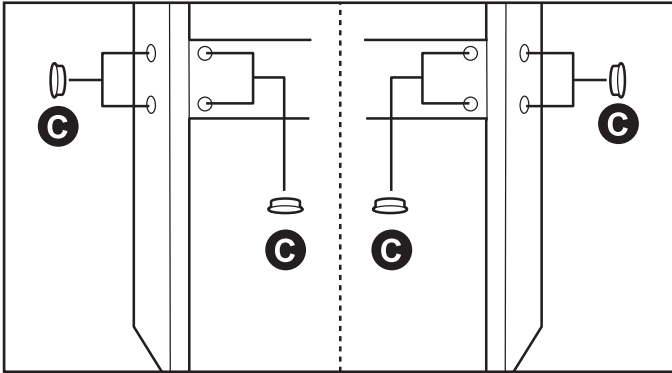

Pedal Parts and Hardware

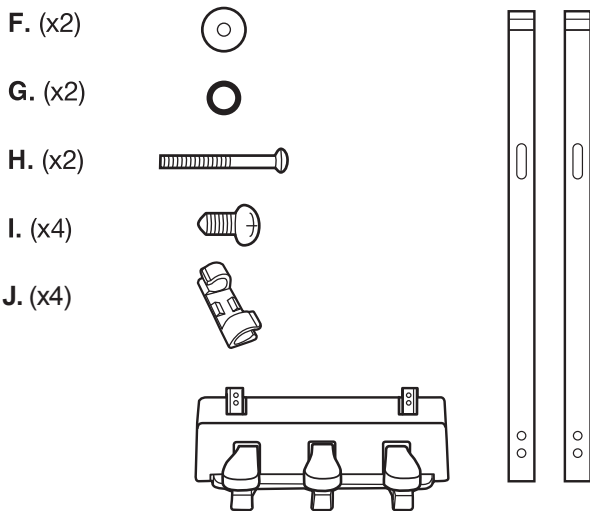

Pedal Assembly

Step 1

Attach the two steel bars to the pedal unit.

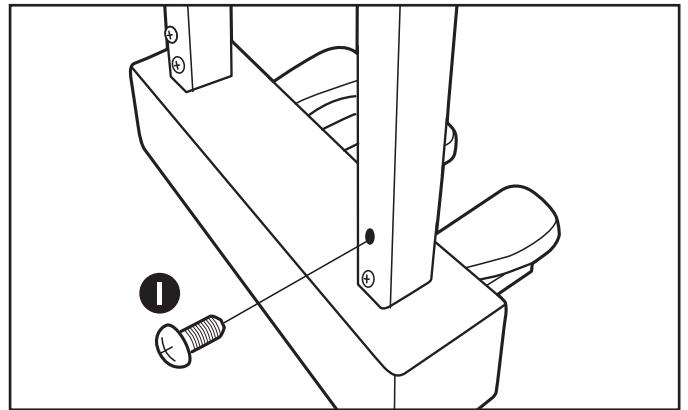

Step 2

Screw the bars into the back of your Williams piano stand. Attach four cable clips to secure the cable.

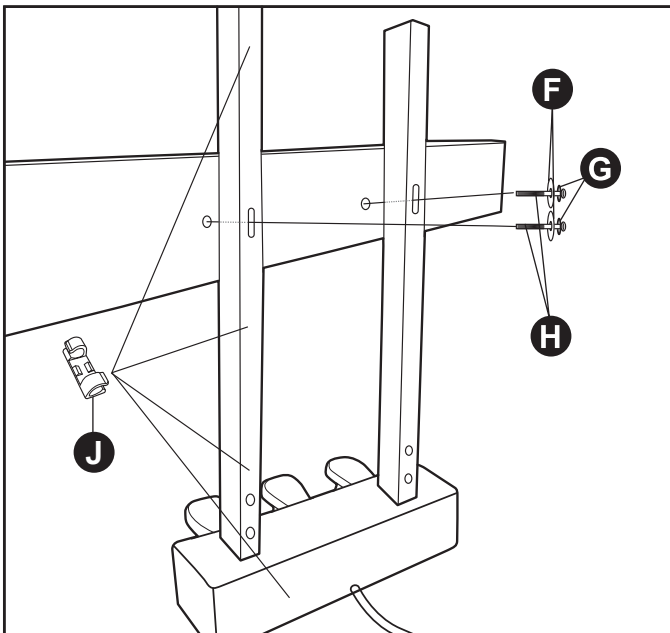

Step 3 - Attaching Piano to Stand

Lift the piano onto its stand and align the holes in the stand legs with the holes on bottom of the piano. Insert the hand bolts (D), from the stand parts, into each hole to attach the piano to its stand as shown in the insert picture.

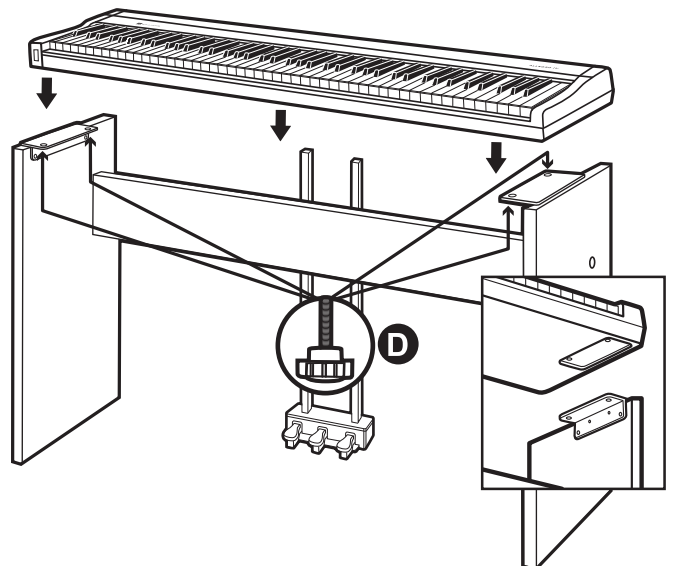

Step 4

Plug the ¼" jacks into the back of your Allegro IV. Use the included clips to hide cables behind the stand.

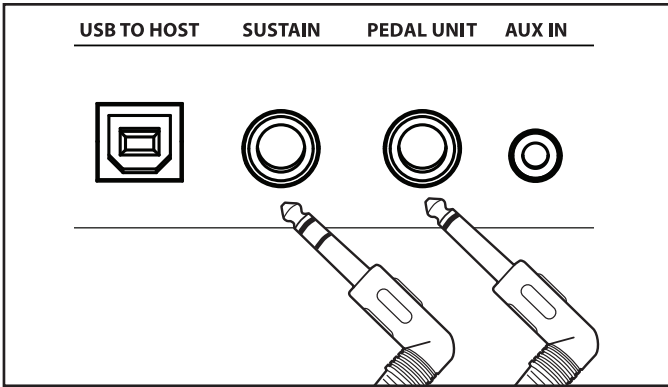

Bench Assembly

1. Loosen the wing nuts (A) until they are able to be pulled together.
2. While squeezing the wing nuts together, slide the pins into the slots in the metal bar on the backside of the bench.
3. Adjust the height of the bench using the same method. The farther the pins are from the center, the shorter the bench will be. Then, tighten the wing nuts to secure the bench legs. Adjust the orientation of the rubber feet to level the bench.

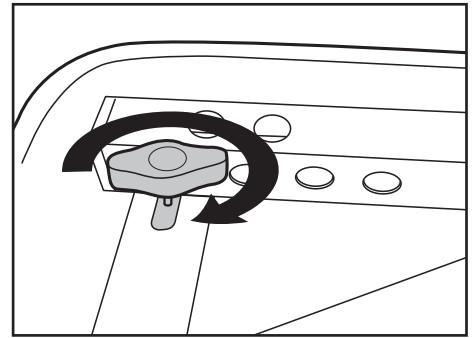
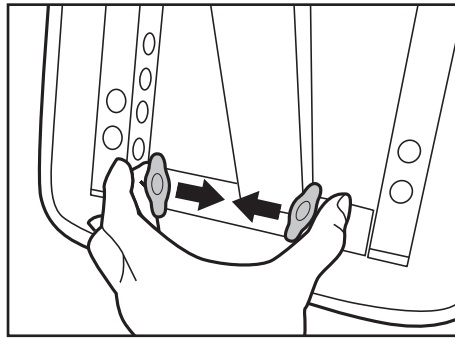
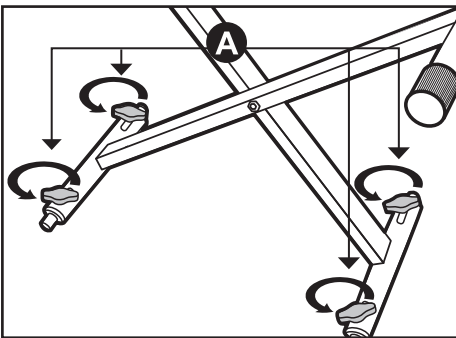

Please refer to the included Allegro IV Reference Manual for operation of the rest of the piano.



OR VISIT OUR WEBSITE AT: WILLIAMSPIANOS.COM

10506793-V1.0

2303-231083031